

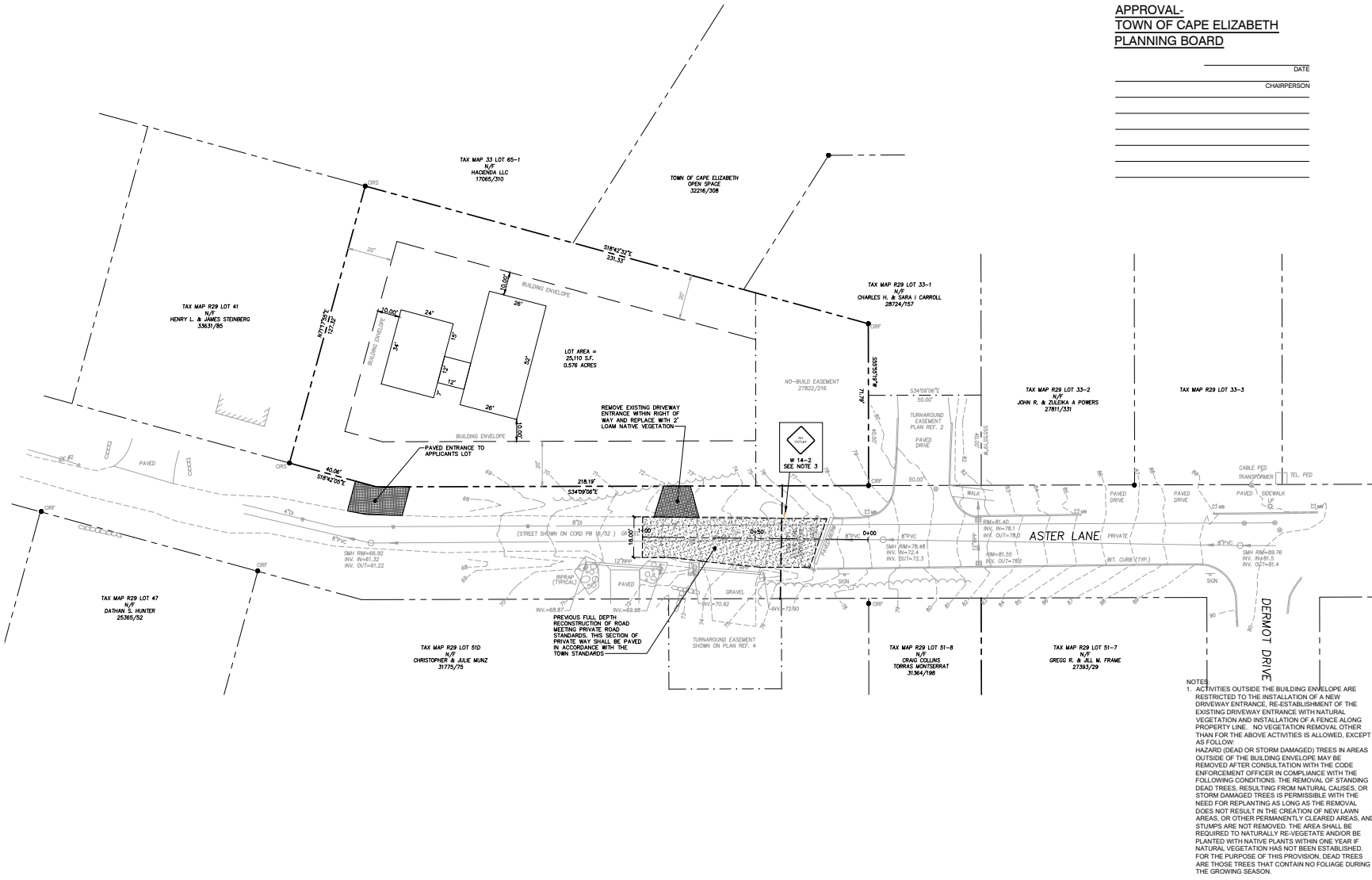

NORTH

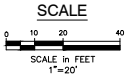

OVERALL SITE PLAN
SCALE: 1" = 20' (H)



PLAN REFERENCE:
1. BOUNDARY & TOPOGRAPHIC SURVEY PREPARED BY OWEN HASSELL, INC. DATED MARCH 12, 2018 AND REVISED DATED APRIL 27, 2018. STAMPED BY JOHN W. SWAN PLS#1038. JOB NO. 2017-373-CE

APPROVAL-
TOWN OF CAPE ELIZABETH
PLANNING BOARD

DATE
CHAIRPERSON

PRIVATE ROAD
EXTENSION
AMENDMENT
8 ASTER LANE
CAPE ELIZABETH, MAINE
Prepared for:
MARGARET BIRLEM
8 ASTER LANE
CAPE ELIZABETH, MAINE

CIVIL ENGINEER
STEPHEN J. BRADSTREET, PE #5740
400 COMMERCIAL STREET, SUITE 404
PORTLAND, ME 04101
207-772-2891

RANSOM
Consulting, LLC.
800 Commercial Street, Suite #04
Portland, ME 04101
Tel: (207) 772-2891
Fax: (207) 772-2248
www.ransomconsulting.com

OVERALL SITE PLAN

D	DRIVEWAY AMENDMENT	01/26/21
C	APPROVED PLANS	10/15/19
B	PRELIMINARY PLAN REVIEW	04/30/18
A	COMPLETENESS REVIEW	03/30/18

No.	Revision/Issue	Date

Design by: SJB	Checked by: SJB
Drawn by: PM	Approved by: SJB
Project: 181.06027	Date: MAY 2018
Sheet No: C-100	Sheet 1 of 2

NOTES:
1. ACTIVITIES OUTSIDE THE BUILDING ENVELOPE ARE RESTRICTED TO THE INSTALLATION OF A NEW DRIVEWAY ENTRANCE, RE-ESTABLISHMENT OF THE EXISTING DRIVEWAY ENTRANCE WITH NATURAL VEGETATION AND INSTALLATION OF A FENCE ALONG PROPERTY LINE. NO VEGETATION REMOVAL OTHER THAN FOR THE ABOVE ACTIVITIES IS ALLOWED, EXCEPT AS FOLLOWS:
HAZARD (DEAD OR STORM DAMAGED) TREES IN AREAS OUTSIDE OF THE BUILDING ENVELOPE MAY BE REMOVED AFTER CONSULTATION WITH THE CODE ENFORCEMENT OFFICER IN COMPLIANCE WITH THE FOLLOWING CONDITIONS: THE REMOVAL OF STANDING DEAD TREES, RESULTING FROM NATURAL CAUSES, OR STORM DAMAGED TREES IS PERMISSIBLE WITH THE NEED FOR REPLANTING AS LONG AS THE REMOVAL DOES NOT RESULT IN THE CREATION OF NEW LAWN AREAS, OR OTHER PERMANENTLY CLEARED AREAS, AND STUMPS ARE NOT REMOVED. THE AREA SHALL BE REQUIRED TO NATURALLY RE-VEGETATE AND/OR BE PLANTED WITH NATIVE PLANTS WITHIN ONE YEAR IF NATURAL VEGETATION HAS NOT BEEN ESTABLISHED. FOR THE PURPOSE OF THIS PROVISION, DEAD TREES ARE THOSE TREES THAT CONTAIN NO FOLIAGE DURING THE GROWING SEASON.
2. THE EXISTING PRIVATE ROAD EXTENSION SHALL BE PRIVATELY MAINTAINED IN ACCORDANCE WITH THE DECLARATION OF COVENANTS WITH RESPECT TO ROAD MAINTENANCE AND SHALL NOT BE THE RESPONSIBILITY OF THE TOWN OF CAPE ELIZABETH.
3. A "NO OUTLET" (W 14-2) SIGN SHALL BE PLACED AS SHOWN ON THIS PLAN.

1/20/2021 4:47 PM 181.06027.DWG